



CPD REQUIREMENTS FOR ARCHITECTS AND SURVEYORS

The CPD Standards Office is a unique organisation and was founded with the vision of understanding and enabling positive and successful CPD and learning experiences. As a highly specialised expert team, our university led research has equipped us with extensive expertise on all things CPD.

Between the work of the Professional Development Consortium and the CPD Standards Office dual CPD research and accreditation activities sharpen our knowledge and expertise. This enables us to work with individual coaches, training providers, employers, and 'membership organisation's as a collaborative CPD network & community.

CPD Requirements for Architects and Surveyors

The Main Professional Body for Architects

The professional body for architecture is the Royal Institute of British Architects (RIBA).

Once a qualified member, Architects must complete 35 CPD hours per annum where half of these hours must be structured. Structured CPD activities are those that are planned and verifiable, and have learning aims or objectives e.g. a course or event.

RIBA Core Curriculum Topics

Architects must also dedicate 20 hours on ten mandatory RIBA core curriculum topics which include:

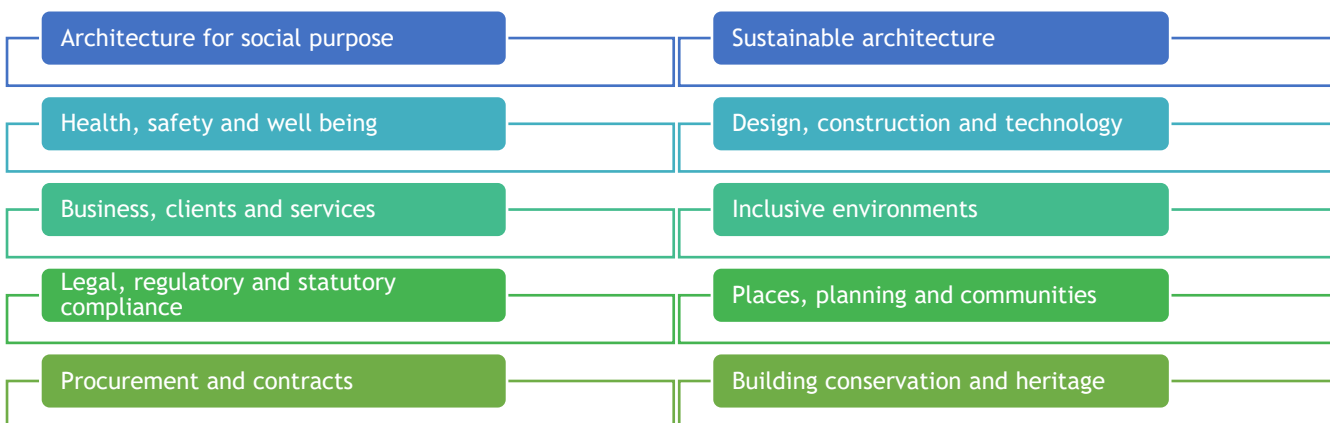

Architect Magazines

Here is a selection of magazines that we recommend reading:

- Architects read the following trade magazines:
- Architects Journal - Weekly
- Architectural Review - Monthly
- Building Design - Weekly
- RIBA Journal - Daily Online

We recommend advertising or organising an editorial to feature in these journals to promote yourselves to this group.

Architect Events

Architects attend organised events such as:

New London Architecture -

<http://www.newlondonarchitecture.org/>

- Offer a variety of events

Architecture -

<https://www.architecture.com/whats-on>

-Shows all the upcoming events

We recommend you attend or exhibit at these events to promote yourselves to this market.

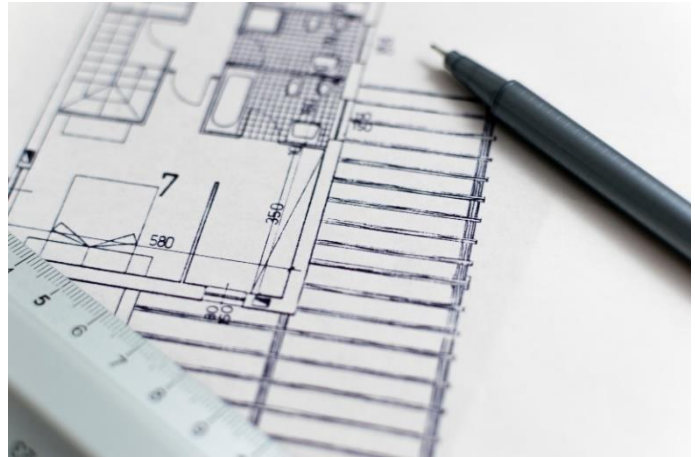

The Main Professional Body for Surveyors

Surveyors are members of the Royal Institute of Chartered Surveyors (RICS). Once qualified and chartered, they are expected to do 20 hours of CPD per calendar year. These hours must then be recorded on the RICS online system by 31 January.

Surveyors have the freedom to choose the topics that they cover for CPD purposes. The only requirement is that every 3 years they must undertake CPD on Global Professional and Ethical Standards.

The 20 hours must be split as 10 formal learning hours, and 10 informal learning hours. The RICS provides the following diagram for surveyors to categorise their hours see:

http://www.rics.org/Global/CPD_decision_tree_17102016_TP.pdf

To find out more...

Take a look at this link to see more about professional bodies in this sector see:

https://www.cpdstandards.com/sector-requirements/sector-requirement-search/?_sft_category=building-construction-property

Surveyors Magazines

Here is a selection of magazines that we recommend Surveyors read:

- Surveyor - Weekly
- RICS Building Surveying Journal - Monthly

We recommend advertising or organizing an editorial to feature in these journals to promote yourselves to this group.

Surveyor Events

Surveyors can attend organised events throughout the year, here are two websites which list all the upcoming events:

Highways Management - <https://highways.tn-events.co.uk/>

-Shows all the upcoming events

RICS - <http://www.rics.org/uk/training-events/>

-Offers knowledge on the upcoming years events



We hope you have found this factsheet helpful.

Please see www.cpdstandards.com for more information on our accreditation services or call 0203 745 6463 for further advice.